

**4.75 IN/120.65MM
 TORPEDO DIA.**

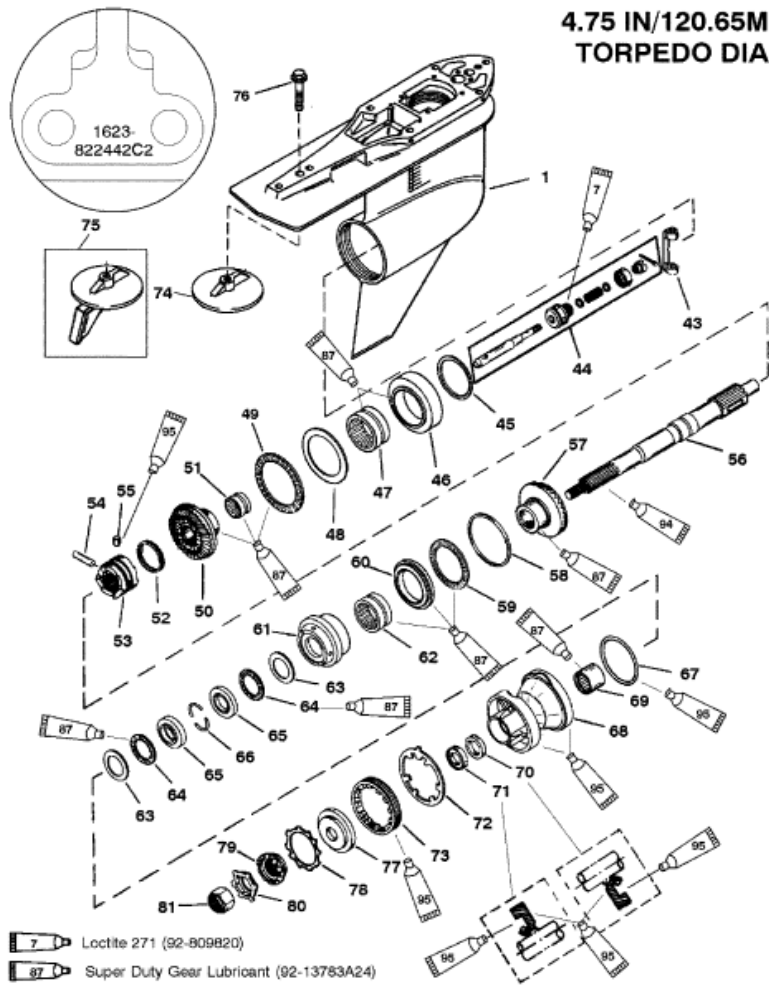

- Loctite 271 (92-809820)
- Super Duty Gear Lubricant (92-13783A24)
- Anti-Corrosion Grease (92-78376A6)
- 2-4-C With Teflon (92-825407A12)

Parts List

Ref	Class	Part	Description	Qty	Comment	Footnote
1	1623	822442A25	GEAR HOUSING	1	(BASIC-BLACK)	
1	1623	822442A26	GEAR HOUSING	1	(BASIC-GRAY) WHEN EXISTING	
59	31	15841	ROLLER BEARING	1		
60	12	17616	THRUST RING	1		
61		818292A 1	BEARING ADAPTOR ASSEMBLY	1		
62	31	814653	ROLLER BEARING	1		
63	12	18448	THRUST WASHER	2		
64	31	15842	THRUST BEARING	2		
65		818291 1	THRUST RACE	2		
66		814605	KEEPER	2		
67	25	31534	O RING	1		9
68		818290A 1	BEARING CARRIER ASSEMBLY	1		
69	31	30956	ROLLER BEARING	1		
70	26	14077	OIL SEAL (INSIDE)	1		9
71	26	76868	OIL SEAL (OUTSIDE)	1		9
72	14	18323	TAB WASHER	1		
73		79448	COVER	1		
74		76214A 5	ANODIC PLATE	1	THESE REPLACEMENT PARTS.	
75		822777A 1	TRIM TAB	1	(ANODIC) THESE REPLACEMENT PARTS.	
75		822777 3	TRIM TAB	1	(BLACK ALUMINUM) THESE REPLACEMENT PARTS.	
76	10	806327	SCREW	1	THESE REPLACEMENT PARTS.	
77	12	835467	THRUST HUB	1	THESE REPLACEMENT PARTS.	
78	13	42351 1	LOCKWASHER	1	THESE REPLACEMENT PARTS.	
79	12	31211A 2	WASHER	1	THESE REPLACEMENT PARTS.	
80	14	816629	TAB WASHER	1	THESE REPLACEMENT PARTS.	
81	11	52707A 1	PROPELLER NUT	1	THESE REPLACEMENT PARTS.	
-	26	816575A 5	G/H SEAL KIT	1		